

Stevens Crescent TOTTERDOWN

APPROXIMATE FLOOR AREA
94.2 SQM / 1014 SQFT

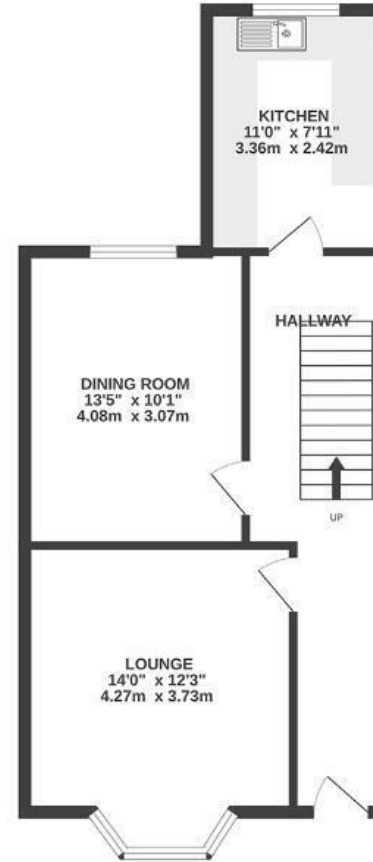

GROUND FLOOR



FIRST FLOOR



Boardwalk

Stevens Crescent , BRISTOL



£325,000



2 Bedrooms



BS3 4UH



1 Bathrooms

"We love the look of the Maisonette with it's Victorian red brick and stone facade. Inside it feels so homely, with some nice period features, an enormous master bedroom and a huge bathroom. It's a really friendly street-we love sitting drinking coffee in the living room bay, slightly above street level, watching the world go by. Our only regret is not having added a roof terrace - you would have the most amazing views over Bristol."

